

SEWARD

CARLISLE

SCHOHARIE

RICHMONDVILLE

MIDDLEBURG

FULTON

STEEP SLOPE
TOWN OF COBLESKILL
SCHOHARIE COUNTY, NEW YORK

SARGENT - WEBSTER - CRENSHAW & FOLLEY
ARCHITECTS ENGINEERS PLANNERS



1963



SLOPE IN EXCESS OF 15%

CONTOUR INTERVAL 20 FEET

The preparation of this map for the New York State Department of Commerce was financially aided through a Federal Grant from the Urban Renewal Administration of the Housing and Home Finance Agency, and in part by the State of New York, under the Urban Planning Assistance Program authorized by Section 701 of the Housing Act of 1954, as amended.

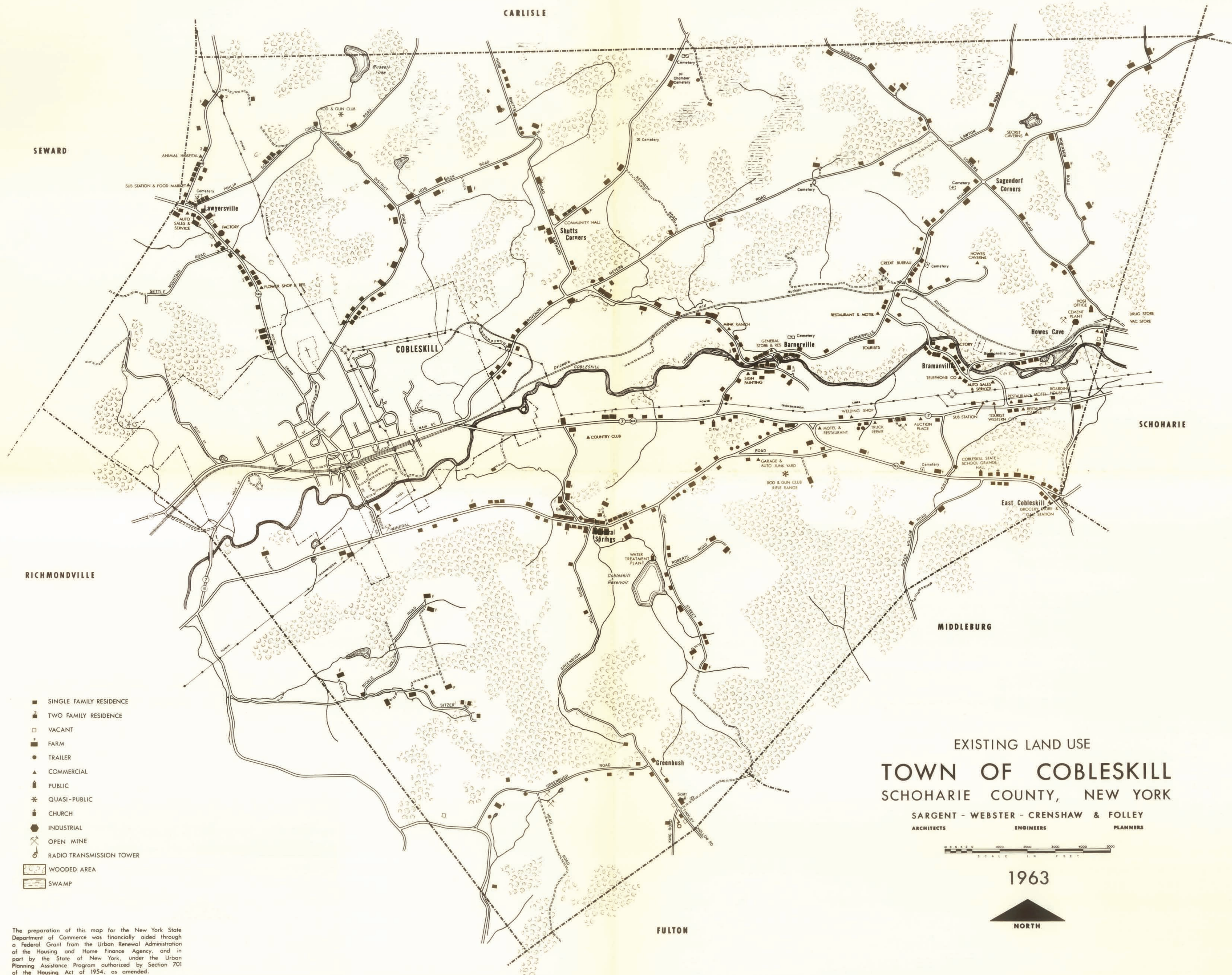

The preparation of this map for the New York State Department of Commerce was financially aided through a Federal Grant from the Urban Renewal Administration of the Housing and Home Finance Agency, and in part by the State of New York, under the Urban Planning Assistance Program authorized by Section 701 of the Housing Act of 1954, as amended.

- | | | | |
|--|-------------------------|----|---------------------------|
| | SINGLE FAMILY RESIDENCE | • | TRAILERS |
| | TWO FAMILY RESIDENCE | F | FARMS |
| | MULTI-FAMILY RESIDENCE | HO | HOME OCCUPATION |
| | COMMERCIAL RETAIL | UC | UNDER CONSTRUCTION |
| | COMMERCIAL SERVICE | PK | PARKING |
| | INDUSTRIAL | | CENTRAL BUSINESS DISTRICT |
| | PUBLIC | | |
| | QUASI-PUBLIC | | |
| | CROP LAND | | |
| | WOODED LAND | | |
| | OPEN LAND | | |



NOTE:
 Lines indicate land use only and are not necessarily legal boundaries.
 Field survey by Sargent-Webster-Crenshaw & Folley May 1963

The preparation of this map for the New York State Department of Commerce was financially aided through a Federal Grant from the Urban Renewal Administration of the Housing and Home Finance Agency, and in part by the State of New York, under the Urban Planning Assistance Program authorized by Section 701 of the Housing Act of 1954, as amended.

EXISTING LAND USE
VILLAGE OF COBLESKILL
 SCHOHARIE COUNTY, NEW YORK





SARGENT - WEBSTER - CRENSHAW & FOLLEY
 ARCHITECTS ENGINEERS PLANNERS



1963



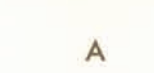

-  ONE FAMILY RESIDENCE
-  TWO FAMILY RESIDENCE
-  MULTI-FAMILY RESIDENCE
-  AUXILIARY BUILDINGS
-  CENTRAL BUSINESS DISTRICT BOUNDARY

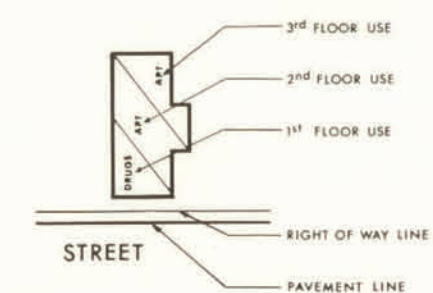

EXISTING LAND USE
CENTRAL BUSINESS DISTRICT
VILLAGE OF COBLESKILL
SCHOHARIE COUNTY, NEW YORK

SARGENT - WEBSTER - CRENSHAW & FOLLEY
ARCHITECTS ENGINEERS PLANNERS



1963



The preparation of this map for the New York State Department of Commerce was financially aided through a Federal Grant from the Urban Renewal Administration of the Housing and Home Finance Agency, and in part by the State of New York, under the Urban Planning Assistance Program authorized by Section 701 of the Housing Act of 1954, as amended.

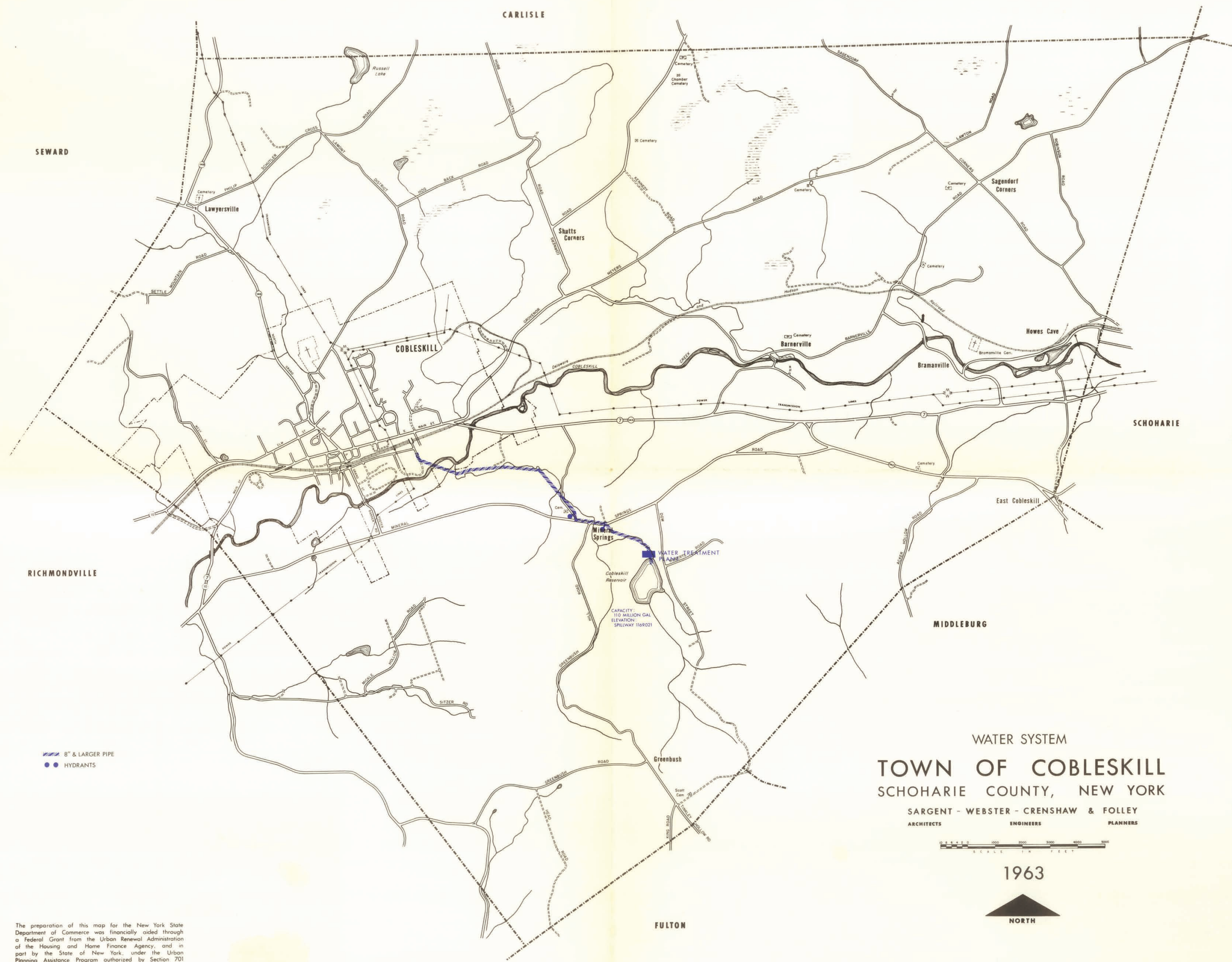

8" & LARGER PIPE
HYDRANTS

WATER SYSTEM
TOWN OF COBLESKILL
SCHOHARIE COUNTY, NEW YORK
SARGENT - WEBSTER - CRENSHAW & FOLLEY
ARCHITECTS ENGINEERS PLANNERS



1963



The preparation of this map for the New York State Department of Commerce was financially aided through a Federal Grant from the Urban Renewal Administration of the Housing and Home Finance Agency, and in part by the State of New York, under the Urban Planning Assistance Program authorized by Section 701 of the Housing Act of 1954, as amended.

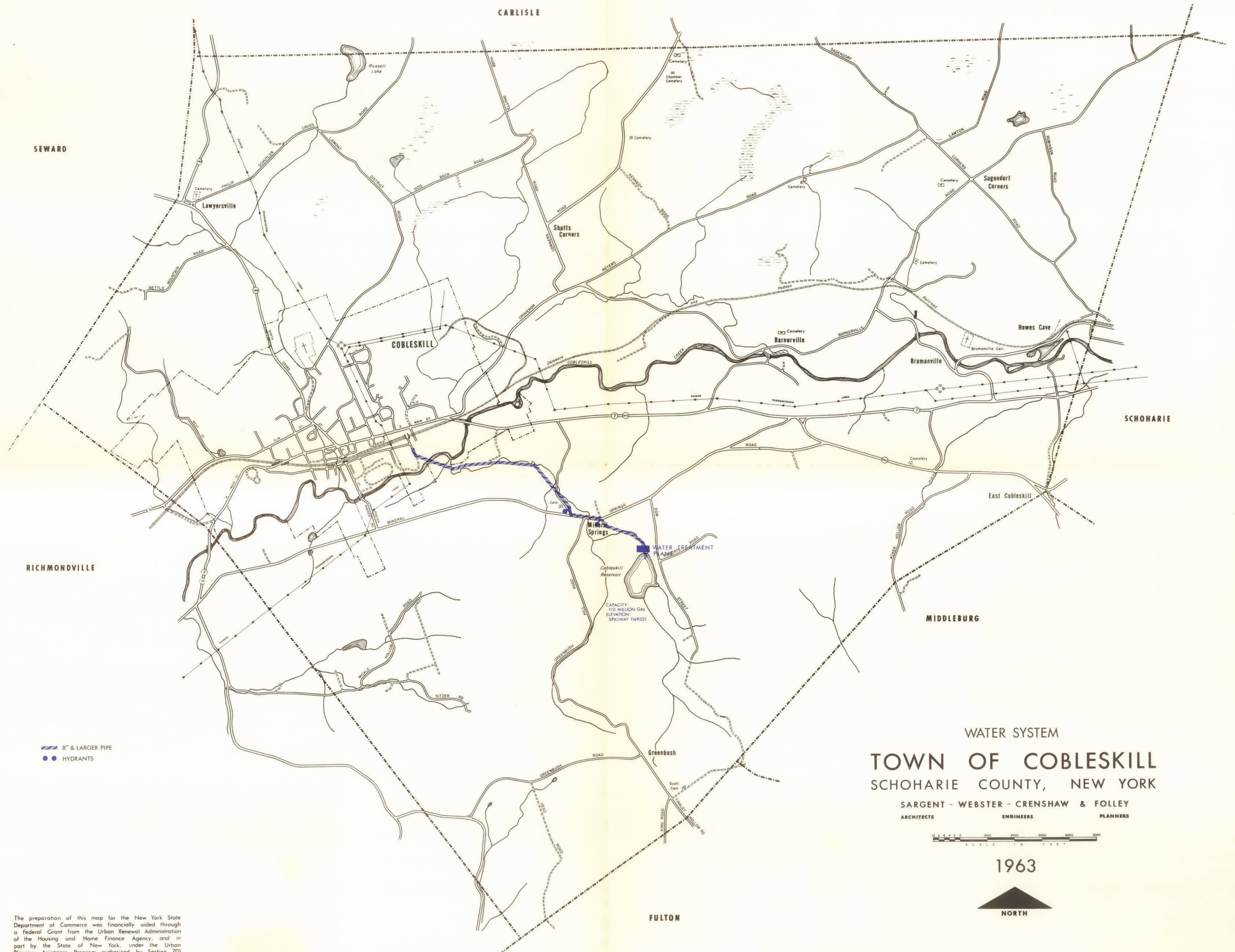

WATER SYSTEM
TOWN OF COBLESKILL
 SCHOHARIE COUNTY, NEW YORK
 SARGENT - WEBSTER - CRENSHAW & FOLLEY
 ARCHITECTS ENGINEERS PLANNERS



1963



The preparation of this map for the New York State Department of Commerce was financially aided through a Federal Grant from the Urban Renewal Administration of the Housing and Home Finance Agency, and in part by the State of New York, under the Urban Planning Assistance Program authorized by Section 701 of the Housing Act of 1954, as amended.

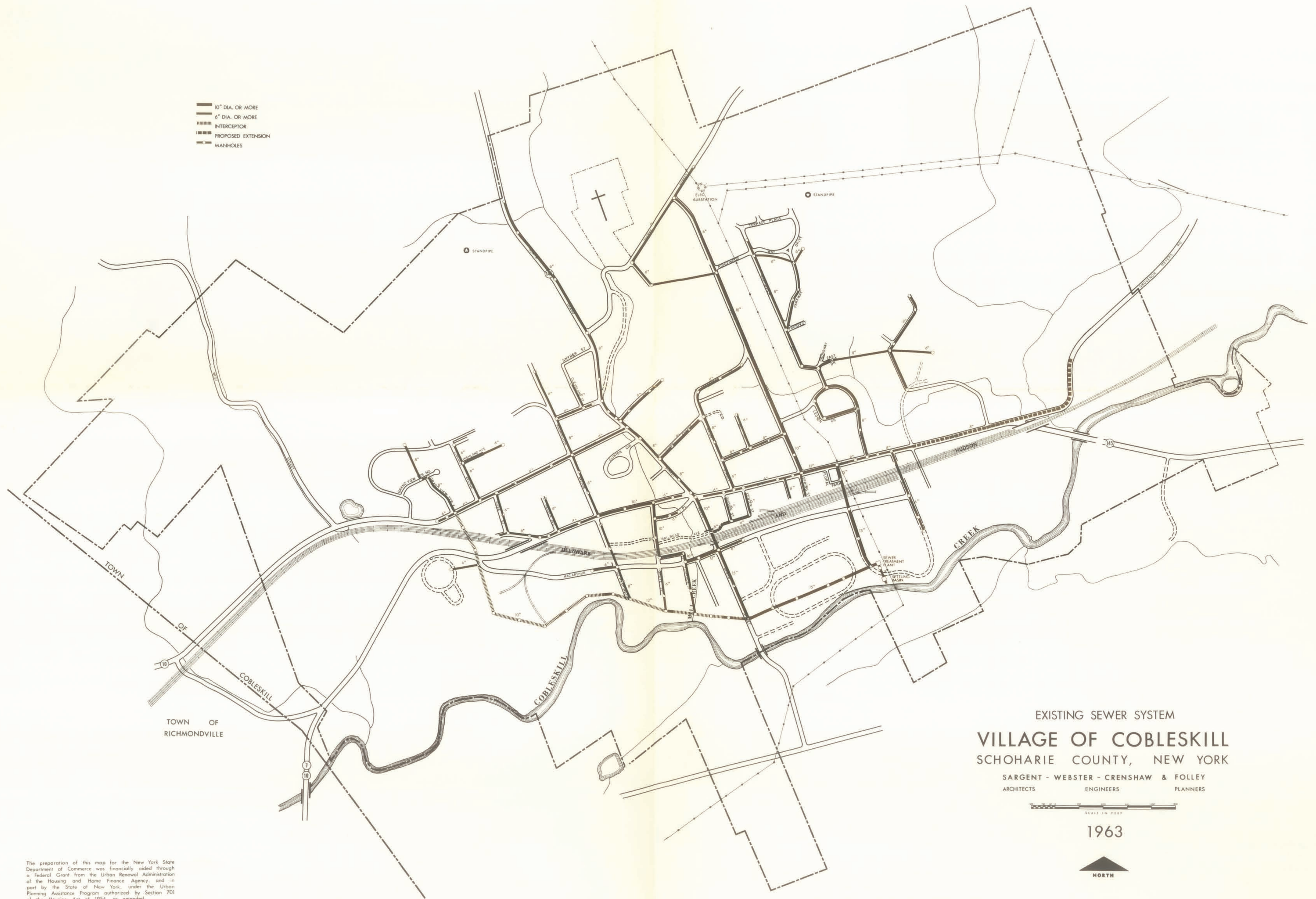

EXISTING SEWER SYSTEM
VILLAGE OF COBLESKILL
 SCHOHARIE COUNTY, NEW YORK

SARGENT - WEBSTER - CRENSHAW & FOLLEY
 ARCHITECTS ENGINEERS PLANNERS



1963



The preparation of this map for the New York State Department of Commerce was financially aided through a Federal Grant from the Urban Renewal Administration of the Housing and Home Finance Agency, and in part by the State of New York, under the Urban Planning Assistance Program authorized by Section 701 of the Housing Act of 1954, as amended.

-  SCHOOLS
-  PUBLIC BUILDINGS
-  CHURCHES
-  PRIVATE RECREATION FACILITIES
-  YOUTH RECREATION PROGRAMS
-  PUBLIC AREAS
-  QUASI-PUBLIC BUILDINGS OR AREAS
-  PARKS

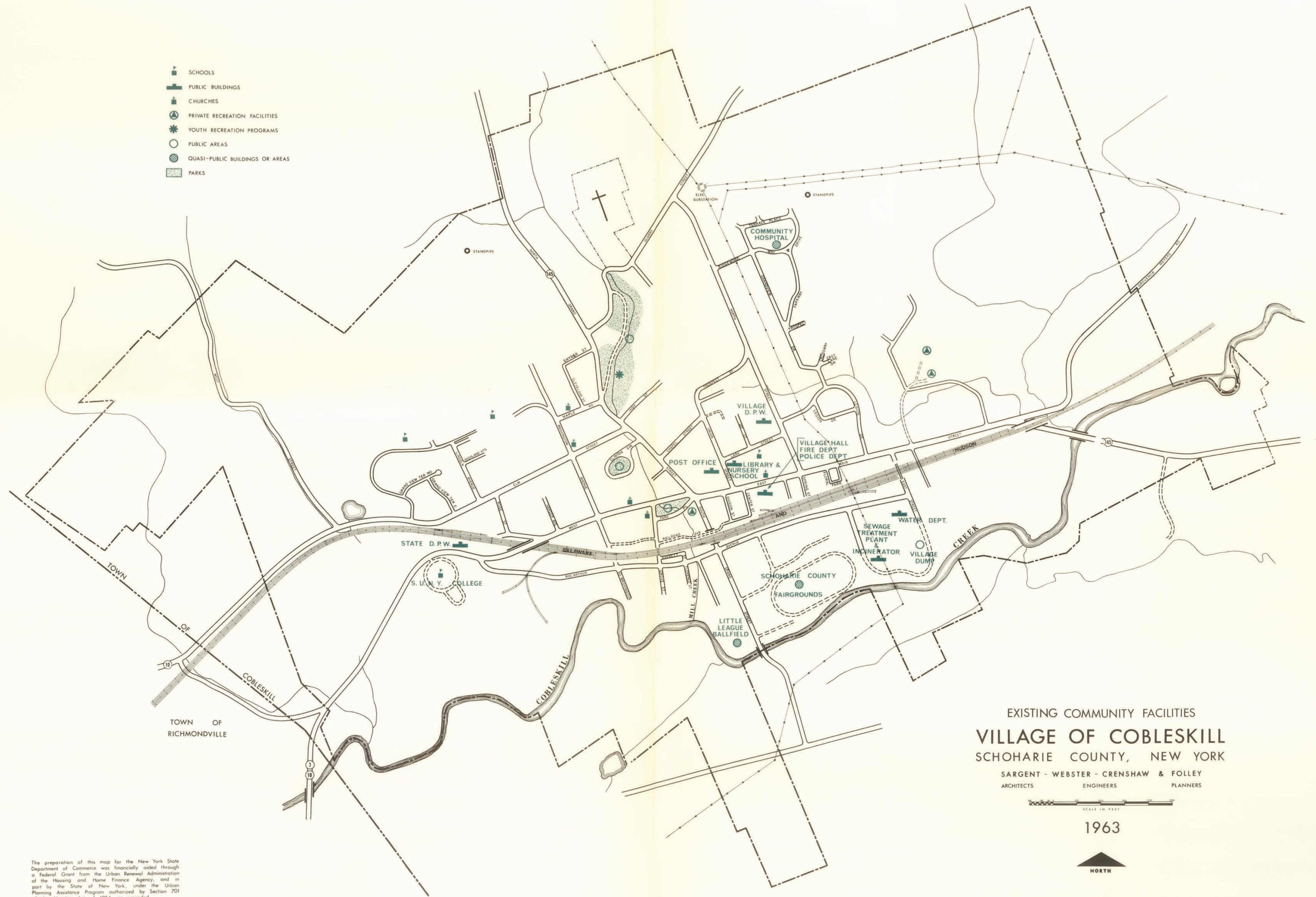

EXISTING COMMUNITY FACILITIES
VILLAGE OF COBLESKILL
 SCHOHARIE COUNTY, NEW YORK

SARGENT - WEBSTER - CRENSHAW & FOLLEY
 ARCHITECTS ENGINEERS PLANNERS

SCALE IN FEET

1963



The preparation of this map for the New York State Department of Commerce was financially aided through a Federal Grant from the Urban Renewal Administration of the Housing and Home Finance Agency, and in part by the State of New York, under the Urban Planning Assistance Program authorized by Section 701 of the Housing Act of 1954, as amended.

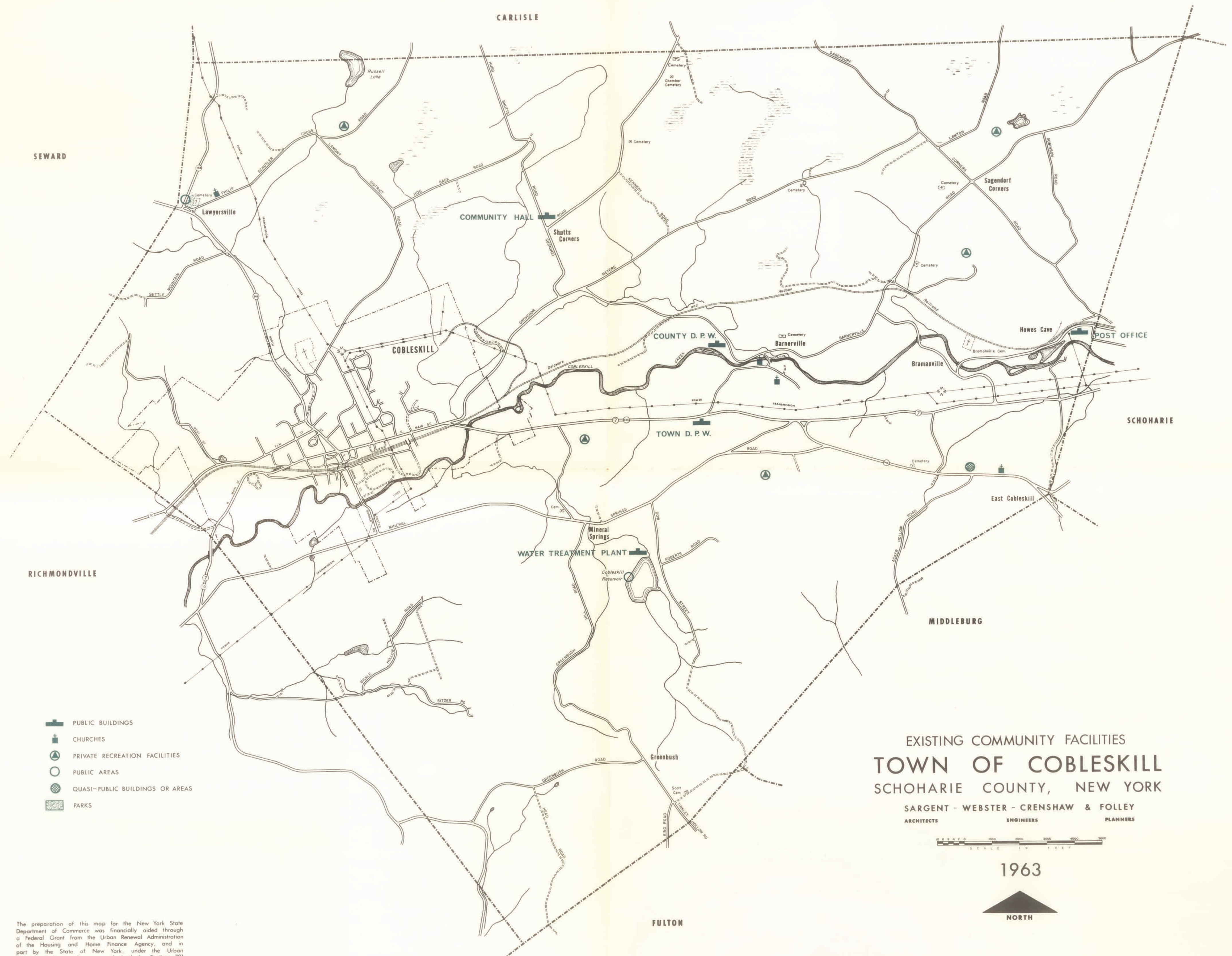

The preparation of this map for the New York State Department of Commerce was financially aided through a Federal Grant from the Urban Renewal Administration of the Housing and Home Finance Agency, and in part by the State of New York, under the Urban Planning Assistance Program authorized by Section 701 of the Housing Act of 1954, as amended.